

[View this email in your browser](#)



Newsletter July 5, 2023

## LPRO Neighbourhood Survey Update



There was an excellent response to the survey of those in the neighbourhood that are included in our mailing list with over 400 responses. Thank you to everyone who took the time to do so!

Generally the survey indicated a high level of support for the activities that LPRO is currently engaged in, particularly Safety, Housing and Environment.

There were many comments as well which are extremely helpful and will be taking us a bit of time to go through and assess. We hope to provide further feedback in future newsletters, on the website and finally an in depth review at our Annual General Meeting which is planned for this fall.

---

A number of people indicated that they would be willing to volunteer in some capacity. However since the survey was anonymous we don't know who you are. It would be very much appreciated if you could drop a note to our mail email address [lyttonparkresidentsorg@gmail.com](mailto:lyttonparkresidentsorg@gmail.com) to let us know who you are, and if you indicated an area you would like to assist with what that was. The list provided on the survey was

- Communications (newsletters and website)
- Volunteer Recruitment
- Planning, development and related activities
- Community Safety (crime prevention, street safety)
- Events and community engagement
- Other (please specify))

---

## Awareness = Prevention

### My Community Watch

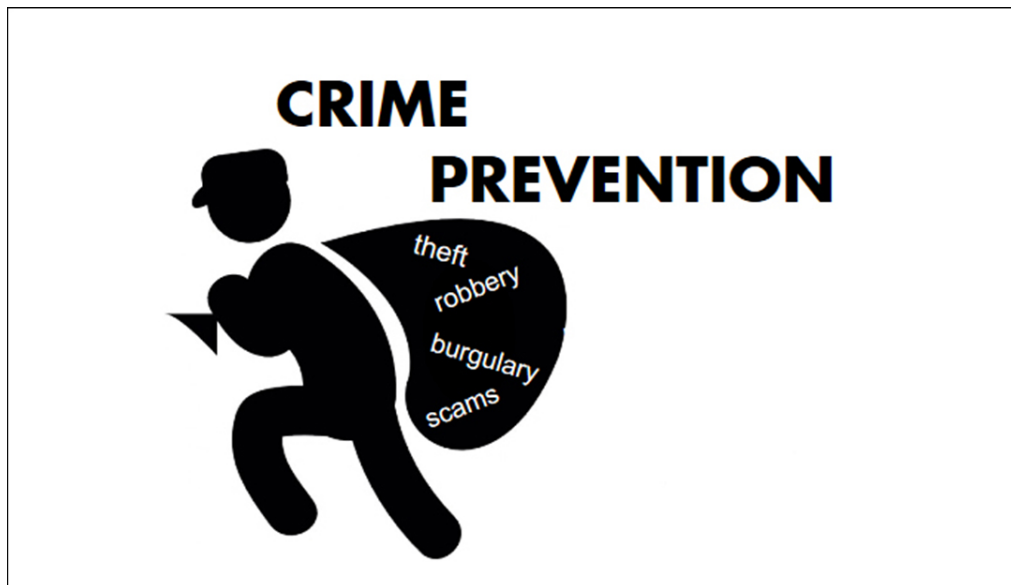

My Community Watch is a free crime notification service, using verified public police data to notify you by email of all reported crimes in your area.

You have the flexibility to choose the type of crimes you wish to be notified about, the proximity to your home and how often you wish to be advised by email.

It's a free service created by volunteers who were concerned with crime in their Etobicoke neighbourhood. They have now expanded the program city-wide and to other Canadian and US cities.

For more information and to sign-up click on this link:

---

## Ban on Two-stroke Engine Equipment



At its June 28 meeting the Infrastructure and Environment Committee (IEC) recommended that Council support a ban on the use of two-stroke small engine equipment and ask the Mayor to include adequate resources in the 2024 budget to initiate the work to enact a bylaw imposing a ban. IEC has also asked Council to direct Staff to report back to IEC by December 31, 2023 on the opportunities for clean transition support programs with community organizations, service providers, equipment manufacturers and/or retailers, and recommend an approach to transitioning towards alternative equipment practices for residents, businesses and commercial operators who provide services using two-stroke engine equipment. Council will consider IEC's recommendation at its meeting on July 19 - 21.

---

## Eglinton Park Master Plan Update

---





LPRO is a member of the Eglinton Park Master Plan Community Advisory Group. The Master Plan is currently in Phase I. The Group had its third meeting in early June. The discussion centred on the design of the five elements of Phase I: Central Spine Path, Heritage Themed Gardens, Dog Off-leash Park, Skate Spot (Skateboarding), and improvements to the Existing Stairs at Oriole Parkway.

A wider public consultation will take place this summer with contract tendering this fall, construction starting in the Spring of 2024 and completion of this Phase I in the fall of 2024.

You can make your opinions heard by taking this City of Toronto survey: [project webpage here](#).

Subsequent phases of the park's revitalization will take place following completion of Phase I. No schedule or consultations have been set for the additional phases at this time.

In other Eglinton Park news, pending approval by new mayor Olivia Chow and Toronto City Council, the park will be part of a pilot project where you will be able to consume beer or wine. The Pilot will run between August 2 and October 9.

---

## **2500 Yonge Street (Capital Theatre) Construction Hub Update**

Monthly meetings continue as planned with the Developer of 2500 Yonge, City of Toronto Construction Hub Manager, the Uptown Yonge BIA, and LPRO. The excavation phase should be finished by the end of July and will result in a

---

sharp reduction in large trucks needing to access the site. During the meeting we presented several issues and are working to resolve them as soon as possible:

- Establish a no-idling policy that adheres to the City of Toronto anti-idling by-law
- Reduce street parking infractions and eliminate blocking of residential driveways
- Ensure adequate 'Flag People' are present at key locations
- Continue with the dampening of dust in the site proximity
- Paint the Yonge St hoarding with a green paint



*The excavation phase is almost complete!*

LPRO is also collaborating with our neighbouring resident group south of Roselawn, Eglinton Park Residents Association (EPRA), who are the community representatives for the 2400 Yonge Construction Hub (between Roselawn and Montgomery). That site, along with the upcoming 500 Duplex and 34 Montgomery (a proposed development on Montgomery between Yonge and Duplex), means ongoing construction in our area for the next several years. LPRO and EPRA are working to give a voice to local residents who are most affected and press for solutions to their concerns.

---

## 500 Duplex Update

The mediated settlement for the proposed development at 500 Duplex has now been approved by Toronto City Council and all involved parties.

We reported the details in our last newsletter. Since then we have received drawings that provide a visual perspective. For more information see the [500 Duplex page](#) on our website.

---

# Another Successful Yard Sale!

Earlier this month 115 homes participated in our Annual Community Yard Sale. The weather cooperated with plenty of sunshine and gave us an opportunity to meet neighbours, bargain for deals and sell unwanted household items. Thank you to everyone who participated in another successful Yard Sale and to the volunteers who made it work!

---

## Board Member and Volunteer Profile: Alica Du

Alicia is a busy mom with two very young children. She works in the finance field and her husband is in the real estate sector.

How long have you lived in Lytton Park? [8 years in total.](#)

What attracted you to move here? [Great schools and beautiful streets. It is a perfect neighbourhood for families](#)

Have they met your expectations? [Totally! I can't imagine moving anywhere else.](#)

What would you like to see improved in our community? [As a mom of two, I am concerned about street safety \(i.e., speeding and running stop signs\) as our streets get busier. Dust and pollution are also worse because of construction. I also hope my neighbours would kindly clean the snow a little bit better in winter, it is so hard to push the buggies around.](#)

How do you engage with the community as a volunteer and why do you do so? [I started volunteering for LPRO during Covid. It is a great way to stay connected with the community and act as a voice for young families.](#)

What are your favourite local restaurants, coffee shops? [It has to be Sorn Thai and De Mello Coffee.](#)

What are your favourite retail stores in our area? [Sporting Life, Lululemon, Pet Valu and La Rocca Cake Boutique.](#)

If you could learn to do anything, what would it be? [Filmmaking](#)

Anything else you would like to say? [As a relatively new board member of the](#)

---

LPRO, I have learned that LPRO has done so much for our community over the years and it takes a lot to keep up with the good work. We are welcoming more volunteers to join us.

---

## Pickleball Anyone??

In keeping up with the increasing popularity of this sport, the City of Toronto has added over 165 new courts and continues to add more. In our neighbourhood, Otter Creek has four new dedicated courts and one combined pickleball/tennis, and Eglinton Park now has two combined pickleball/tennis courts in action. All you need is your own paddles and ball and you're set to have some serious fun!



---

## New Castlefield Park Update

As an interim measure, the space designated for a new park just west of the Capitol Theatre development site will offer recreational activities per the sketch below. It is expected to be ready for use this fall. Once the condo construction is complete in 2025, the larger park concept will be constructed. The projected completion date is sometime in 2026.

---

## 20 Castlefield Avenue – Phase 1 park concept (June 2023)

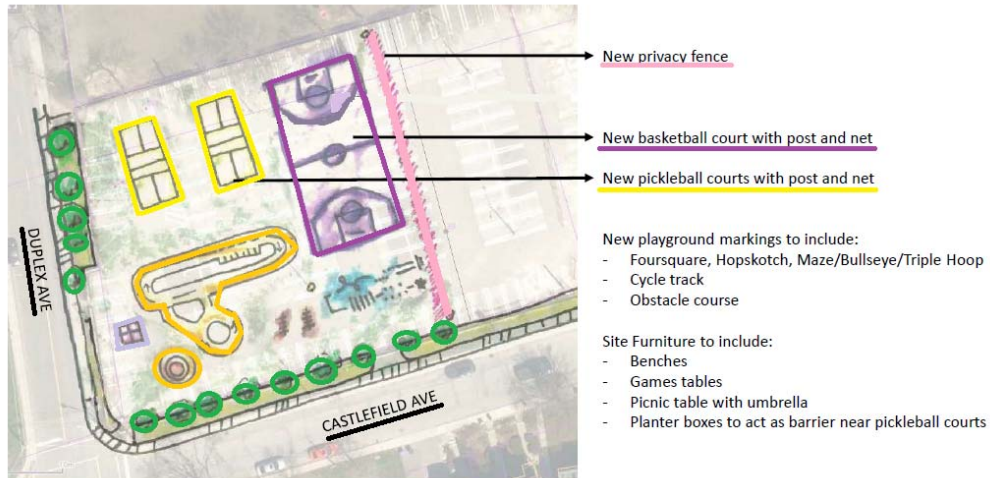

More details can be found in Councillor Colle's newsletter:

<https://www.mikecolletoronto.com/>

---

## Toronto's Night Economy

The City of Toronto is reviewing the licensing and zoning regulations for restaurants, bars and entertainment venues – including nightclubs and live music venues – and exploring strategies to support and enhance Toronto's Night Economy. As part of its review the City will update the definitions, rules, and licensing of these businesses and change regulations that define where they can operate. Details of activities taken place so far, including a completed survey, and what the next steps will be can be found here: [Toronto's Night Economy](#)

---

## Shelter at Former Roehampton Hotel to Close

*From the City of Toronto's Shelter Support and Housing Administration*

The temporary shelter at 808 Mount Pleasant Rd. will close at the end of August 2023. The property owner has been unable to confirm a lease extension beyond August and has submitted a development application for the property.

There are currently approximately 150 residents in the shelter program. The City will continue to work collaboratively with residents to develop permanent housing plans in an effort to move as many shelter residents into housing as

---



possible. To coincide with this work, the number of Community Safety Teams (CST) assigned to support the temporary site will decrease from three teams of two to one team of two that will conduct patrols 24 hours a day, seven days a week. Once the site closes in August, the CST will end operations.

---



The poster features a blue background with a large, faint graphic of a bicycle in the center. The title 'PROJECT BREEZY' is in large yellow letters, and 'BICYCLE DONATION' is in orange. Below the title are two bullet points in yellow text. The 'DROP-OFF' and 'PICK - UP' sections are in white text on black rounded rectangles. The 'Contact Info' section is in white text on a black rounded rectangle. Logos for Gateway Bike Hub and the Toronto Police are in the bottom corners.

# PROJECT BREEZY

## BICYCLE DONATION

- Donate your old or unused bikes to be refurbished and redistributed to families in need.
- Donated as early as March 7th to May 26th and afterword.

**DROP-OFF**

53 Division Toronto Police Service  
@ 75 Eglinton Ave west.  
10 Gateway Blvd Suite 100 B,  
North York, ON M3C 3A1

**PICK - UP**

53 Division Neighbourhood  
Officers will pick -Up

**Contact Info**

PC Marcie Beaven email: [5313@tps.ca](mailto:5313@tps.ca)  
Cell text friendly 647-220-3257  
PC Rob Meloche email: [8291@tps.ca](mailto:8291@tps.ca)  
Cell text friendly 437-421-1067  
[info@gatewaybikehub.org](mailto:info@gatewaybikehub.org)  
(416) 551-2011



---



---

## **Lytton Park Residents' Organization Annual Membership \$30.00 per household How to Join to Renew**

We encourage you to become a member or to renew your membership with Lytton Park Residents' Organization, especially if you care about protecting and advancing the neighbourhood's interests and fostering a sense of community in our area.

Your support helps us vigorously represent our shared neighbourhood interests. There are approximately 3,500 households in the Lytton Park area. Our collective voice has an impressive impact on matters affecting our community.

---

Thank you in advance for supporting your community

How to Join or Renew:

- 1) Online via Credit Card/PayPal: visit <http://www.lyttonparkro.ca/join-volunteer-donate> Please complete the online membership form.
- 2) Interac e-transfer: [etransfer@lyttonparkro.ca](mailto:etransfer@lyttonparkro.ca) Please include your email, name and address in the message box so we know who it's from!
- 3) By cheque payable to Lytton Park Residents' Organization Inc. Cheques with the completed form (below) can be mailed to:  
Lytton Park Residents' Organization Inc., PO Box 1348, 2708 Yonge St.,  
Toronto, ON M4P 3J4

---

Our regular newsletters will continue in September unless something newsworthy that we feel is important to pass on to the local community comes up.

Until then, we want to thank both our members and subscribers for continuing to be part of the LPRO community and wish everyone a wonderful and safe summer!

Together we **DO** make a difference!

**LPRO**

Follow us on Twitter! [@lyttonparkro](https://twitter.com/lyttonparkro) 

PS We encourage people to use the **Forward to a Friend** button below to send this E-newsletter to neighbours who may not have received this. Better yet, ask them to send an email to us asking to be added to our distribution list or to go to our website at <https://lyttonparkro.ca/newsletter-sign-up/>

**Let's keep our community connected!**

 **Forward to a Friend**

---



Our Catchment Area is Yonge St west to Proudfoot, Lawrence south to Roselawn/Briar Hill

If you don't wish to receive these newsletters, please notify us: [lyttonparkresidentsorg@gmail.com](mailto:lyttonparkresidentsorg@gmail.com)

---

This email was sent to <<Email Address>>

[why did I get this?](#) [unsubscribe from this list](#) [update subscription preferences](#)

Lytton Park Residents' Organization · PO Box 1348 Stn K · 2708 Yonge St · Toronto, ON M4P 3J4 · Canada